



MODULAR CLAMPING SYSTEMS

APS: Automatic Positioning System

Reduce setup times by up to 90%!

What is APS?

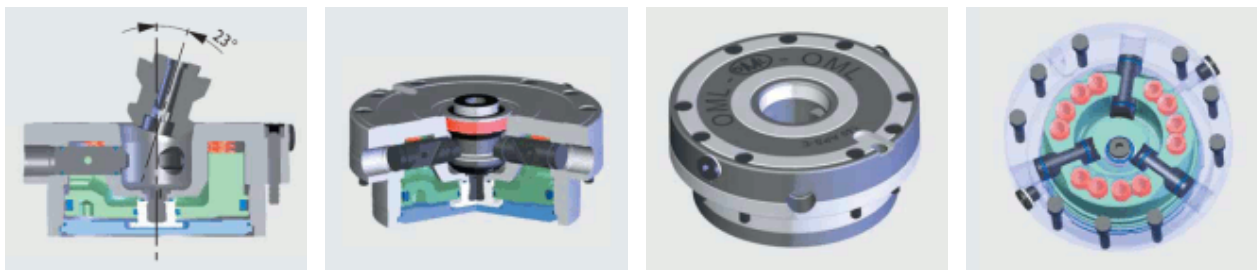

APS (Automatic Positioning System) is a universal connection between the machine tool, the clamping device and/or the workpiece. The flexibility of APS allows accurate positioning and clamping in one operation.

How does it work?

APS performs both positioning and clamping in one operation with repeatability accuracy of < 0.005 mm (0.0002"). APS uses oiled compressed air (6 BAR-85 psi) for unlocking and spring force for clamping. No compressed air is required in the locked condition. Attach the clamping pins (A;B;C) on the clamping devices or on the workpiece and "it's done"!!!

What are the advantages for your company?

Your set-up times will be reduced by 90%! APS offers you greater flexibility in set-up and an increase in productivity resulting in a short payback time

Clamping Pins

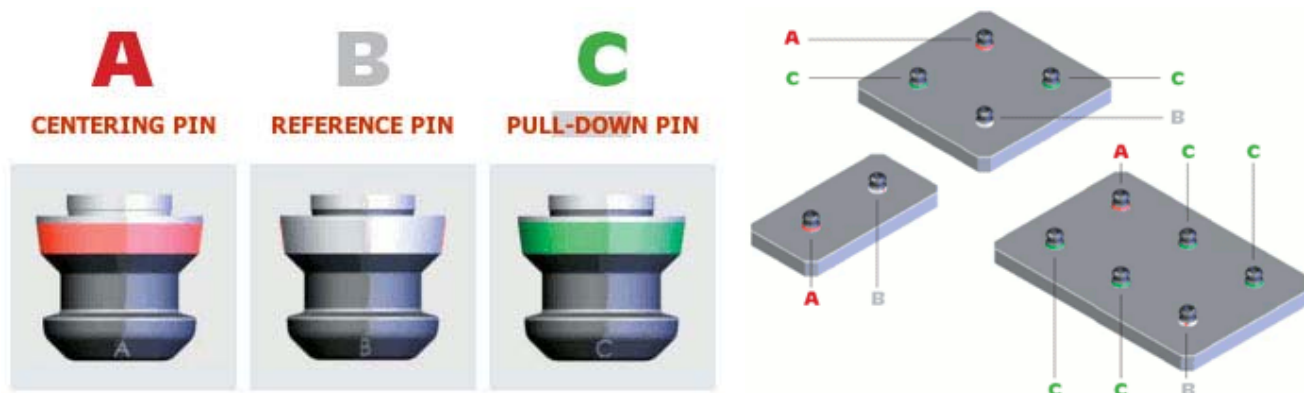

- Positioning and clamping of the devices and/or of the workpiece are achieved through the clamping pins.
- Type A: for centering
- Type B: for reference
- Type C: for clamping.

Technical Features of APS

- Pneumatic System
- 3-Jaw Clamping System
- Mechanical positive locking of the clamping pin by double irreversible wedge
- Pull down force of 30.000 N (6,745 lbs)
- Turbo Effect: The clamping force of the springs is further increased by the compressed air
- Tapered pin allows self-centering clamping
- Repeatability accuracy < 0.005MM (0.0002")

[Click Here to Download Information Sheet \(PDF will open in separate window\) - 2.2 MB](#)



Copyright ©2008-2012 OML. All Rights Reserved.

[HOME](#) | [CURRENT PROMOTIONS](#) | [ABOUT OML](#) | [PRODUCTS](#) | [SALES NETWORK](#) | [CONTACT](#) | [SITEMAP](#)